



6305 6" x 89" Edge Sander Owner's Manual



Oliver Machinery
Seattle, WA
info@olivermachinery.net

M-6305 10/2014
© Copyright 1999-2014
www.olivermachinery.net

WARNING

Safety Note: Thoroughly Read Instruction Manual Prior to Operating Sander

1. WEAR eye protection.
2. SUPPORT work piece with backstop or worktable.
3. KEEP GUARDS IN PLACE and in working order.
4. REMOVE ADJUSTING KEYS AND WRENCHES. Form habit of checking to see that keys and adjusting wrenches are removed from tool before turning it on.
5. KEEP WORK AREA CLEAN. Cluttered areas and benches invite accidents.
6. DON'T USE IN DANGEROUS ENVIRONMENT. Don't use power tool in damp or wet locations, or expose them to rain. Keep work area well lit.
7. KEEP CHILDREN AWAY ALL visitors should be kept safe distance from work area.
8. MAKE WORKSHOP KID PROOF with padlocks, master switches, or by re moving starter keys.
9. DON'T FORCE TOOL. It will do the job better and safer at the rate for which it was designed.
10. USE RIGHT TOOL. Don't force tool or attachment to do a job for which it was not designed.
11. WEAR PROPER APPAREL. Wear no loose clothing, gloves, neckties, rings, bracelets, or other jewelry which may get caught in moving parts. Non-slip footwear is recommended. Wear protective hair covering to contain long hair. Exception: the reference to gloves may be omitted from the instructions for a grinder.
12. ALWAYS USE SAFETY GLASSES. Also use face or dust mask if cutting operation is dusty. Everyday eyeglasses only have impact resistant lenses, they are NOT safety glasses.
13. SECURE WORK. Use clamps or a vise to hold work when practical. It's safer than using your hand and it frees both hands to operate tool.
14. DON'T OVERREACH. Keep proper footing and balance at all times.
15. MAINTAIN TOOLS WITH CARE. Keep tools sharp and clean for best and safest performance. Follow instructions for lubricating and changing accessories.
16. DISCONNECT TOOLS before servicing changing accessories, such as blades, bits, cutters, and the like.
17. REDUCE THE RISK OF UNINTENTIONAL STARTING. Make sure switch is in off position before plugging in.
18. USE RECOMMENDED ACCESSORIES. Consult the owner's manual for recommended accessories. The use of improper accessories may cause risk of injury to persons.
19. NEVER STAND ON TOOL. Serious injury could occur if the tool is tipped or if the cutting tool is unintentionally contacted.
20. CHECK DAMAGED PARTS. Before further use of the tool, a guard or other part that is damaged should be carefully checked to determine that it will operate properly and perform its intended function – check for alignment of moving parts, binding of moving parts, breakage of parts, mounting, and any other conditions that may affect its operation. A guard or other part that is damaged should be properly repaired or replaced.
21. DIRECTION OF FEED. Feed work into a blade or cutter against the direction of rotation of the blade or cutter only.
22. NEVER LEAVE TOOL RUNNING UNATTENDED, TURN POWER OFF. Don't leave tool until it comes to a complete stop.

GROUNDING INSTRUCTIONS

1. All grounded, cord-connected tools: in the event of a malfunction or breakdown, grounding provides a path of least resistance for electric current to reduce the risk of electric shock. This tool is equipped with an electric cord having an equipment grounding conductor and a grounding plug. The plug must be plugged into a matching outlet that is properly installed and grounded in accordance with all local codes and ordinances.

Do not modify the plug provided - if it will not fit the outlet, have the proper outlet installed by a qualified electrician. Improper connection of the equipment grounding conductor can result in a risk of electric shock. The conductor with insulation having an outer surface that is green with or without yellow stripes is the equipment-grounding conductor. If repair or replacement of the electric cord or plug is necessary, do not connect the equipment-grounding conductor to a live terminal.

Check with a qualified electrician or service personnel if the grounding instructions are not completely understood or if in doubt as to whether the tool is properly grounded. Use only 3-wire extension cords that have 3-prong grounding plugs and 3-pole receptacles that accept the tool's plug. Repair or replace damage or worn cord immediately.

2. Grounded, cord-connected tools intended for use on a supply circuit having a nominal rating less than 150 volts. This tool is intended for use on a circuit that has an outlet that looks like the one illustrated in Sketch A in Figure. The tool has a grounding plug that looks like the plug illustrated in Sketch A in Figure. A temporary adapter, which looks like the adapter illustrated in Sketches B and C, may be used to connect this plug to a 2-pole receptacle as shown in Sketch B if a properly grounded outlet is not available. The temporary adapter should be used only until a properly grounded outlet can be installed by a qualified electrician. The green-colored rigid ear, plug, and the like extending from the adapter must be connected to a permanent ground such as a properly grounded outlet box.

3. Grounded, cord-connected tools intended for use on a supply circuit having a nominal rating between 150-250 volts, inclusive: This tool is intended for use on a circuit that has an outlet that looks like the one illustrated in Sketch D in Figure. The tool has a grounding plug that looks like the plug illustrated in Sketch D.

Make sure the tool is connected to an outlet having the same configuration as the plug. No adapter is available or should be used with this tool. If the tool must be reconnected for use on a different type of electric circuit, the reconnection should be made by qualified service personnel; and after reconnection, the tool should comply with all local code and ordinances.

GROUNDING METHODS

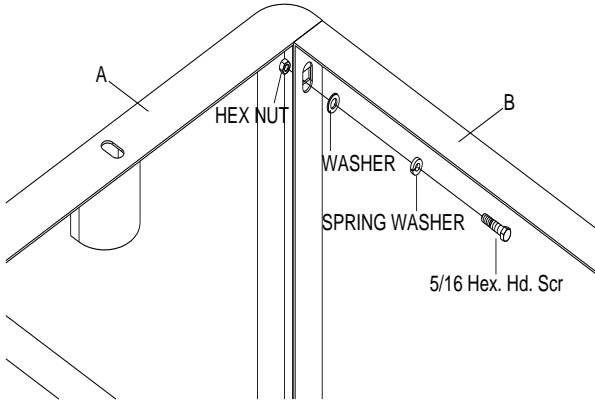
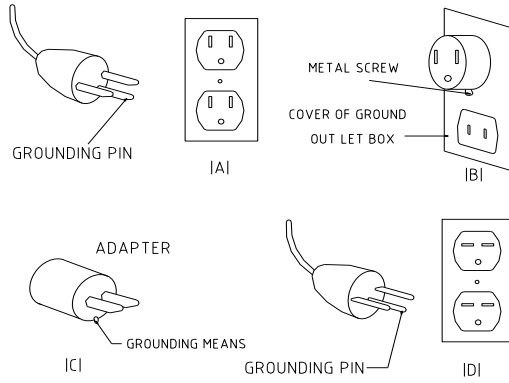

Fig: 1

The way to change sand band

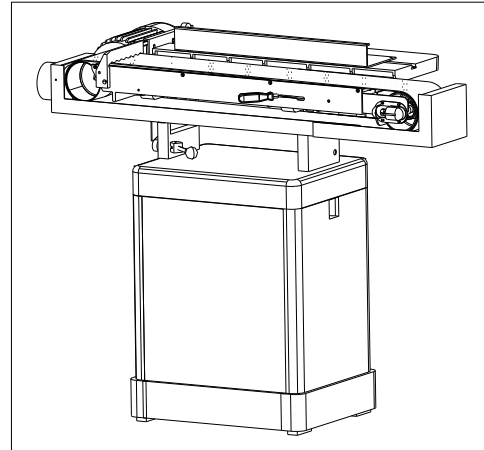

Fig: 3

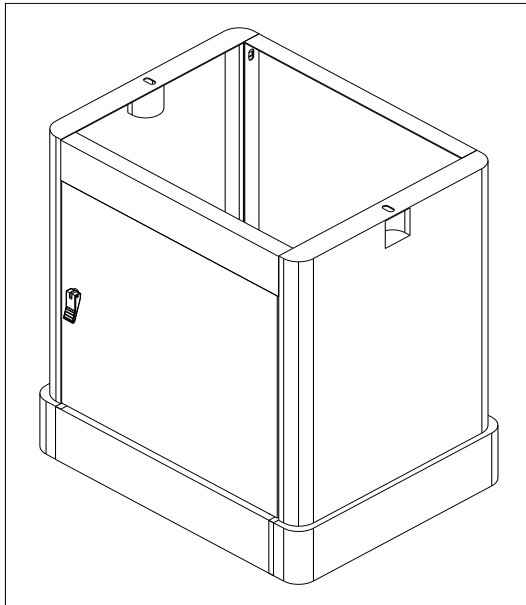

Fig: 2

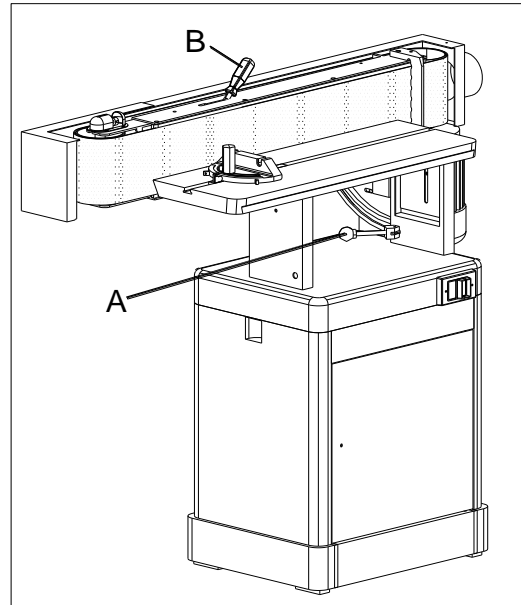

Fig: 4

1. STAND ASSEMBLY : CLAMP PART(A) AND PART(B) BY HEX NUT , WASER, SPRING WASER AND SCREW. SEE.FIG.1
2. STAND ASSEMBLY ,SEE FIG.2

1. SANDING TABLE CAN BE ADJUSTED 90° — 180° ,SEE FIG.4
2. ADJUST CLAMP HANDLE (B) AT DESIRED TO CHANGE NEW BELT. SEE FIG.4
3. LOOSEN ANGLE LOCK KNOB(A) TO SET AND TIGHTEN THE ANGLE.

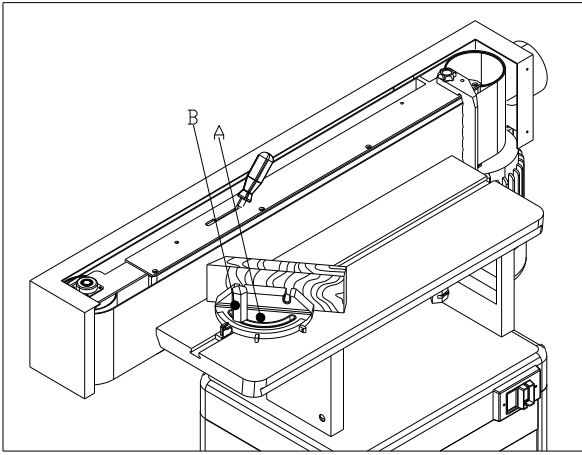

Fig: 5

- 1.MITER GAUGE (A) CAN BE ADJUSTED 45° — 90° AND CLAMPED BY HEX. HANDLE (B), SEE FIG.5
- 2.ADJUST MITER GAUGE(A)2.ADJUST MITER GAUGE(A) TO GET REQUIRED ANGLE GAUGE.

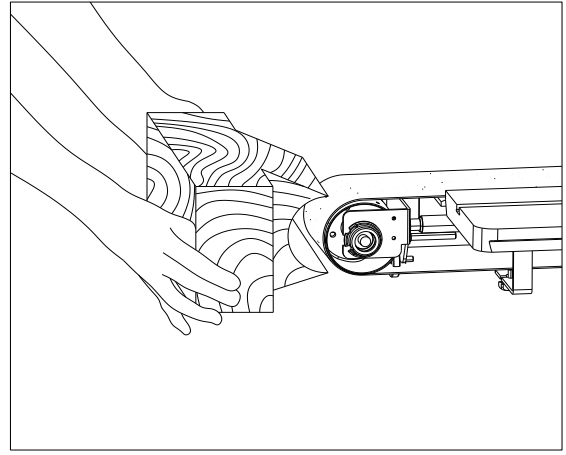

Fig: 7

FOR CONTOUR SANDING SEE FIG. 7

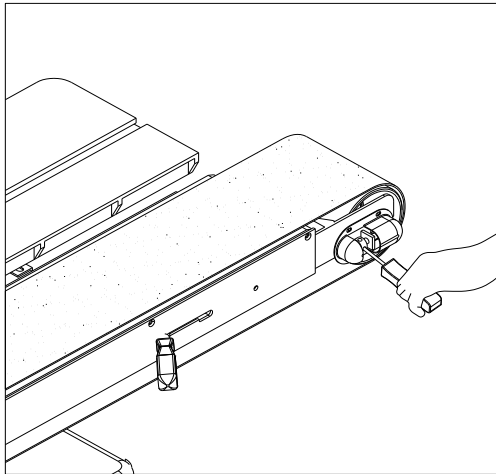

Fig: 6

ADJUST ROLLER TO TRACK BELT SEE FIG. 6

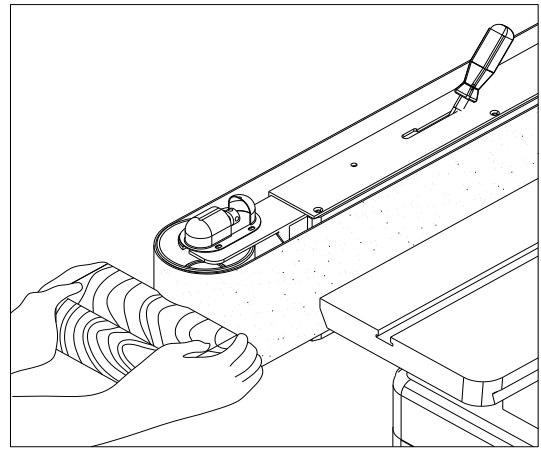

Fig: 7A

FOR CONTOUR SANDING SEE FIG. 7

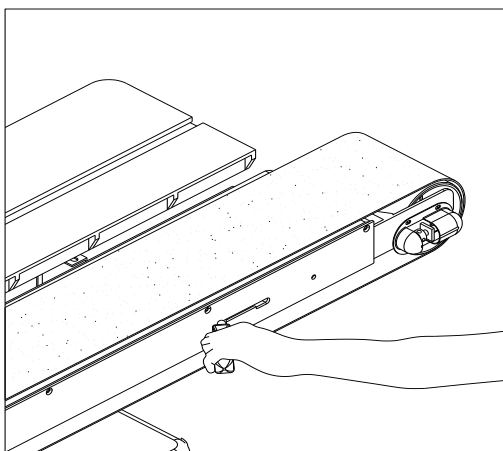

Fig: 6A

ADJUST ROLLER TO TRACK BELT SEE FIG.6

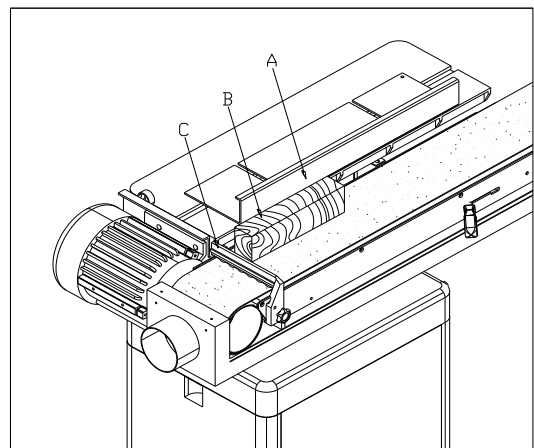
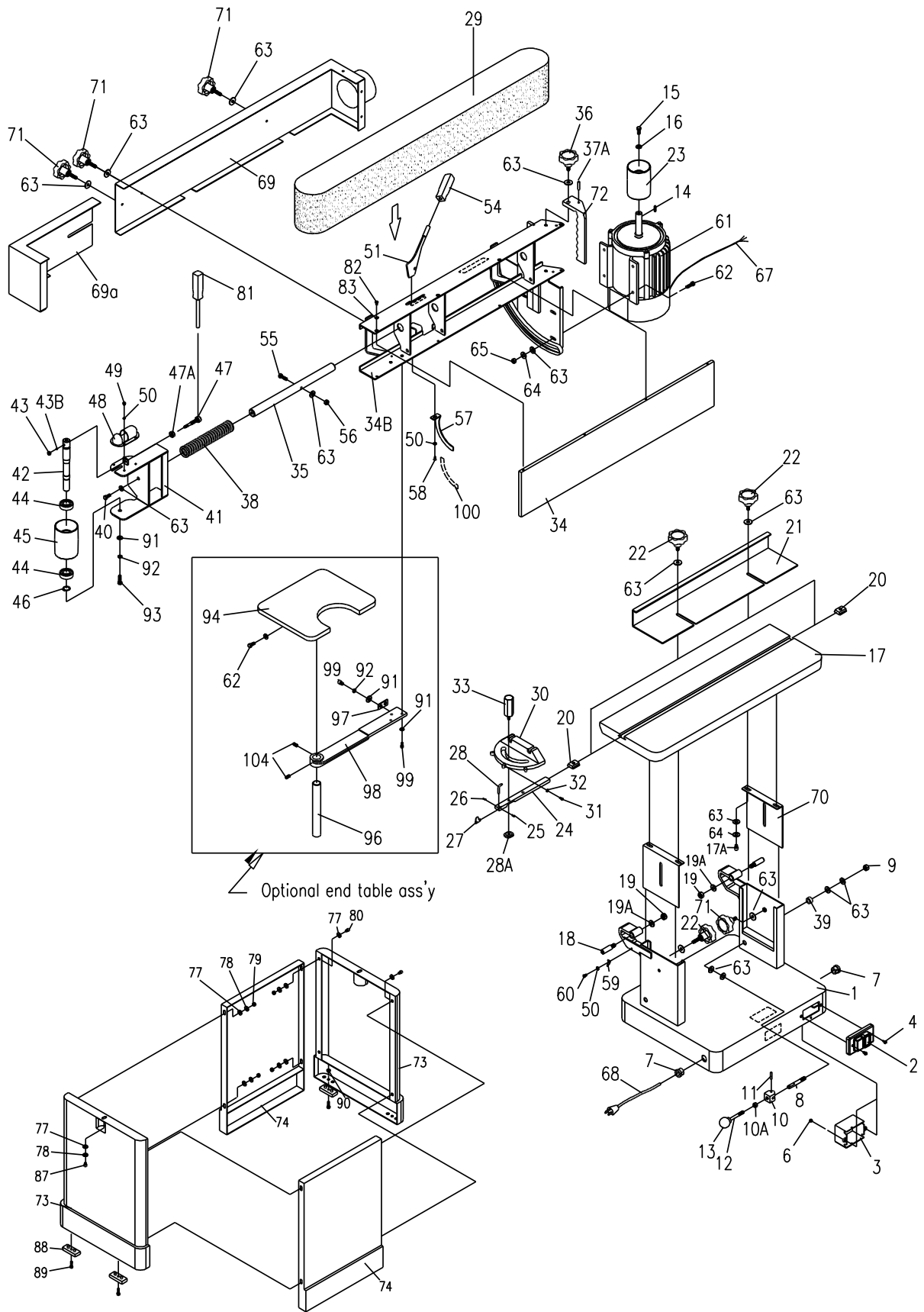

Fig: 8

- 1.MOUNT LOCATING PLATE(A) FOR FLAT SANDING.
- 2.ADJUST KNOB TO CLAMP BRACKET(C) FOR SECURING JOB. SEE FIG. 8
- 3.ANGLE LOCK KNOB(A) TO SET ANGLE AT CERTAIN POSITION.

BOY-80B SCALE=1:14



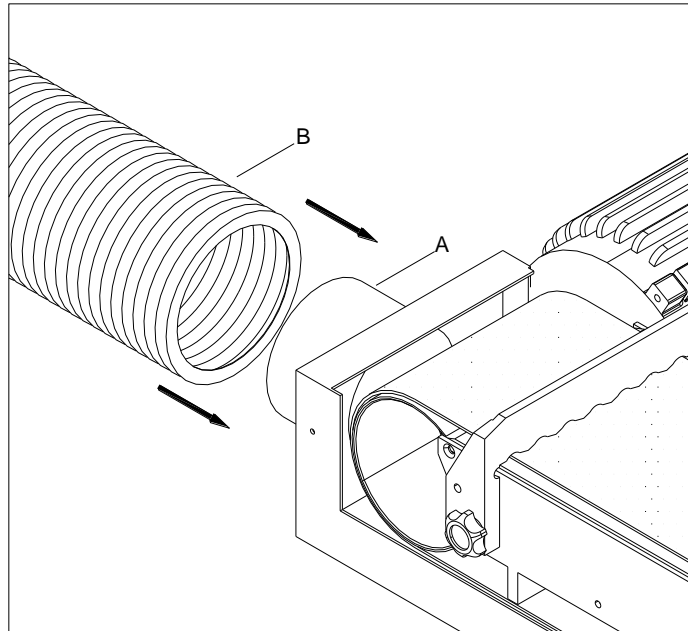
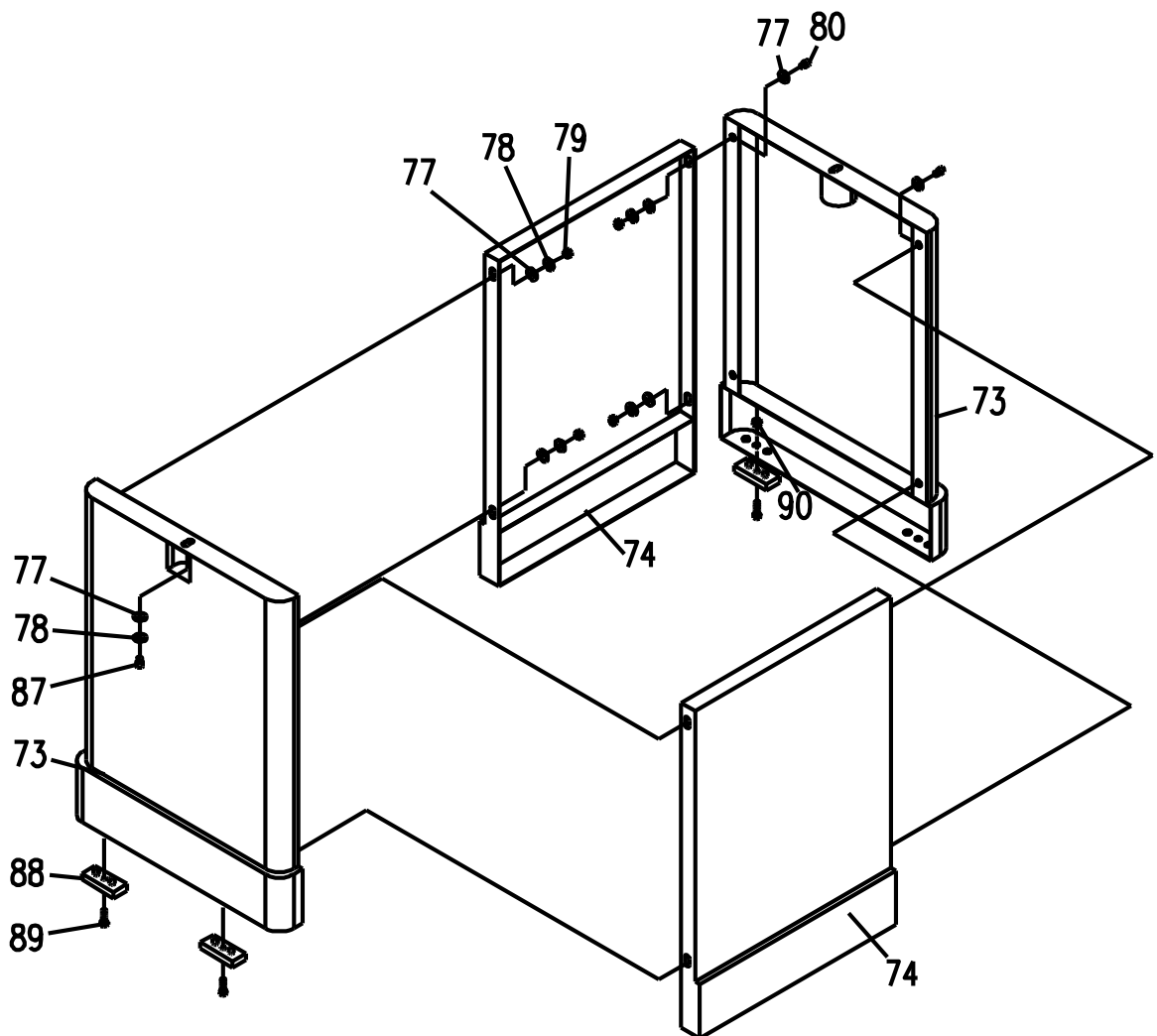

Fig: 9

MAKE SURE DUST HOOD(A) AND HOSE(B) ARE CLAMPED.



PART NO.	DESCRIPTION	REF. NO.	Q'TY
1	BASE	20101001B	1
2	SWITCH	W0000000	1
3	SWITCH BOX	10105052n	1
4	PAN HEAD SCREW 3/16"-24UNC*1-1/2"	S0030324	3
6	NUT 3/16"-24UNC	S0110300	5
7	STRAIN RELIEF	S1017W-2	2
8	WORK TABLE BRACKET	20101005	1
9	LOCK NUT 3/8"-24UNC	S0120380	1
10	CAM ECCENTRIC	20101007	1
10A	NUT 3/8"-16UNC	S0110600	1
11	PIN	S0310525	1
12	LOCK HANDLE	10102024	1
13	HAND KNOB	10102023	1
14	KEY	S0410525	1
15	HEX.HD.SCR. 1/4"-20UNC*1"L	S0020416	1
16	WASHER 1/4"	S0210404	1
17	TABLE	20101011A	1
17A	HEX.HD.SCR. 5/6"-18UNC*5/8"L	S0020510	4
18	SPECIAL SCREW	20101065	2
19	NUT M10*P1.5	S0111000M	2
19A	SPRING WASHER 3/8"	S0210600	2
20	GUIDE BLOCK	20101013	2
21	FENCE	20101014	1
22	KNOB	20101015	3
23	MOTOR ROLLER	20101016	1
24	GUIDE BAR	20102017	1
25	ROLL PIN	S0310306	1
26	SOCKET SET SCREW 1/4"-20UNC*1/4"L	S0050404	1
27	LOCATING PLATE	10104049	1
28	POINTER	10104050	1
28A	LOCATING BLOCK	20102020	1
29	SANDING BELT 6*89	20101021	1
30	MITER GAUGE BODY	10104046	1
31	Rd. Hd. Scr. 5/32"-32UNC*1/2"L	S0030108	3
32	HEX. NUT 5/32"-32UNC	S0110100	3
33	HAND KNOB	10104045	1
34	SANDING TABLE	20101048	1
34B	SANDING TABLE STAND	20101049	1
35	TENSION BAR	20103023	1
36	KNOB	20101039	1
37	PIN	S0310640	1

PART NO.	DESCRIPTION	REF. NO.	Q'TY
38	SPRING	20103025	1
39	SPACER	20101055	1
40	HEX. CAP BOLT 5/16"-18UNC*5/16"L	S0020510a	1
41	ROLLER ARM	20103050A	1
42	SHAFT	20103051	1
43	ANTI-LOOSE NUT 1/4"-20UNC	S0120200	1
43B	STEEL BALL	20103029B	1
44	BEARING	C1106004	2
45	DRIVEN ROLLER	20103028	1
46	RETAINING RING	S0520017	1
47	MICRO-ADJUSTING SCREW	20103029C	1
47A	MICRO-INCHING SCREW	20103029A	1
48	INCHING PROTECTION COVER	20201013	1
49	ROUND CROSS HEAD SCREW 3/16"-24UNC*1/4"	S0030304	4
50	SPRING WASHER 3/16"	S0230300	6
51	BELT REPLACING PLATE	20101031	1
54	SAND CLAMP HANDLE	20101032a	1
55	HEX. HD. SCR. 5/16"-18UNC*1 3/4"L	S0020530	1
56	HEX. NUT 5/16"-18UNC	S0120201	1
57	TILE SCALE	20101033	1
58	ROUND CROSS HEAD SCREW 3/16"-24UNC*3/4"	S0030318	1
59	WIDTH POINTER	10102022	1
60	ROUND CROSS HEAD SCREW 3/16"-24UNC*3/8"	S0030304	2
61	MOTOR	M000010	1
62	HEX. HD. SCR. 5/16"-18UNC*1 1/4"L	S0020520	4
63	FLAT WASHER 5/16"	S0210500C	21
64	SPRING WASHER 5/16"	S0230506	8
65	HEX. HD. SCREW 5/16"-18UNC	S0110500	6
67	MOTOR WIRE	L000000M	1
68	POWER WIRE	L0000000	1
69	BELT COVER	20101038A	1
69A	BELT COVER (SHORT)	20101038a	1
70	LIFTING PLATE	20101002	2
71	KNOB M8*20L	20101024	4
72	BRACKET	20101040	1
73	STAND	30300036	2
74	PARTITION BOARD	30300037	2
77	WASHER 5/16"	S0210500	18
78	SPRING WASHER 5/16"	S0230506	10
79	HEX. NUT 5/16"-18UNC	S0110500	8
80	CAP SCREW 5/16"-18UNC*5/8"L	S0020510	10

PART NO.	DESCRIPTION	REF. NO.	Q'TY
81	BELT TENSION DRIVER	20103044	1
82	CROSS HD. SCREW M5*0.8P*12	S0040512M	8
83	TEETH WASHER 3/16"	S0220300	8
87	CAP SCREW 5/16"-18UNC*1/4"L	S0020520	2
88	RUBBER FEET	10401029	4
89	ROUND HEAD SCREW 5/16"-18UNC*5/8"L	S0090512	4
90	HEX. NUT 5/16"-18UNC	S0110500	4
91	WASHER 1/4"	S0210403	3
92	SPRING WASHER 1/4"	S0230400	2
93	HEX. HEAD SCREW M6*1.0P*16	S0020616M	1
94	EXTENSION TABLE	20101051	1
96	SUPPORTING ROD	20101050	1
97	MOUNTING BRACKET	40101016B	1
98	BRACKET	20101052	1
99	CAP SCREW 1/4"-20UNC*5/8"L	S0020410	5
100	ANGLE LABLE	J0000102	1
101	WARNING LABEL	J2000011	1
104	SOCKET SET SCREW 1/4"-20UNC*3/8"L	S0050406	2